

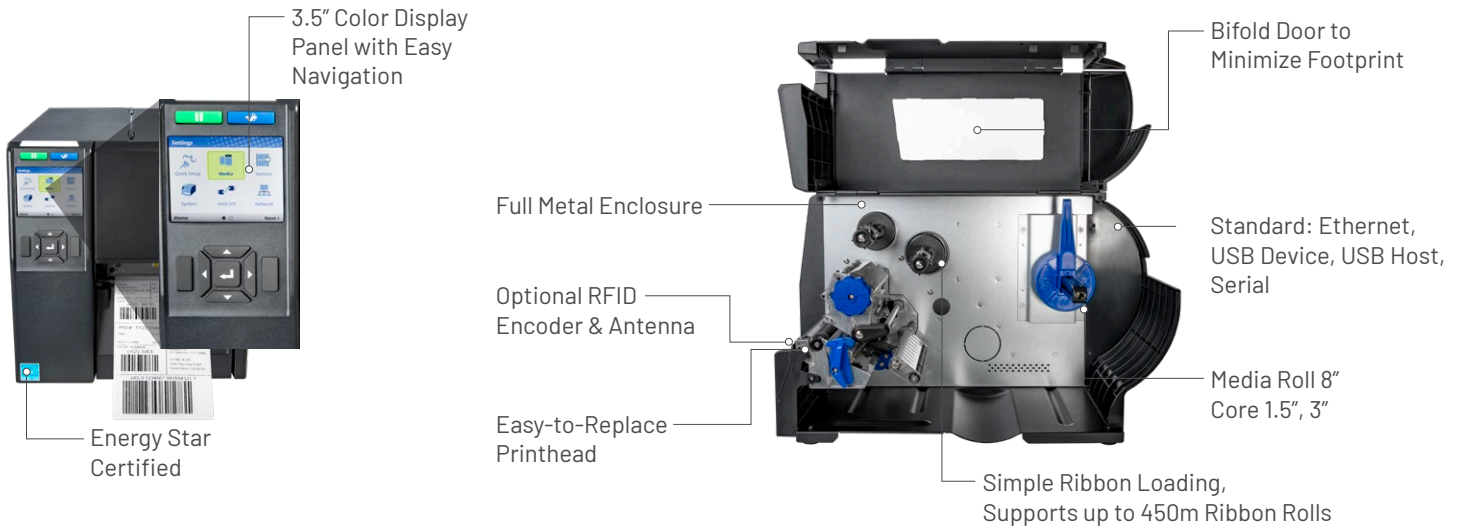

## Key Features



### Enterprise Level Productivity

PSA is an intelligent design platform that combines advanced features with a common set of building blocks to simplify printer installation, operation, and improve productivity.

- The printer includes the tools to install, configure and troubleshoot multiple printers at once.
- Printers are fast and reliable for maximum productivity.
- The time required to perform day-to-day tasks has been minimized.
- Includes multiple connectivity options and advanced security protocols.



### The T4000 RAIN (GS1 EPC Gen2 v2 / ISO 18000-63) system offers several advanced features.

- Encodes and prints on standard RFID paper labels most commonly used in carton or pallet supply chain applications
- Encodes and prints on-metal tags
- Encodes and prints many other tag constructions such as, Returnable Transport Item tags, Electrostatic Discharge tags, and many more
- Validates encoding process, and automatically overstrikes and reprints any RFID label (or tag) that fails to encode properly
- Records all RFID labels for encoding process, tracks success/failure rates



#### Ease of Installation

- Drop-in installation with minimal setup & multiple emulations
- Easy to configure control panel or with interactive webpage
- Full suite of connectivity options & security protocols



#### Ease of Maintenance

- Remotely troubleshoot & monitor printer status
- Push firmware & re-configure printers in batches
- Easy printer swap with quick change memory card (QCMC)
- Commonality of operation between all Printronix Auto ID printers



#### Reliable Label Production

- Easy to use large color LCD display with intuitive icon-driven menu
- Fast print speed and time-to-firstprint
- More uptime with easy load media and large ribbon rolls
- Dependable production up to 5,000 labels per day

# T4000 | Data Sheet

Model	T4000
<b>Resolution</b>	203dpi or 300dpi
<b>Printing method</b>	Direct Thermal and Transfer Thermal
<b>Max. print speed</b>	10ips @ 203dpi, 7ips @ 300dpi
<b>Max. print width</b>	4.1" (104mm)
<b>Media type</b>	Roll or Fan-Fold Labels, Tags, Paper, Film, Tickets
<b>Media handling</b>	Standard: Continuous, Tear-Off Options: Peel/Rewind (paper labels, 6ips, rewinds liner from 8 in roll) Cutter (thickness as per media spec, life 500,000 cuts) (Does not support on-metal RFID labels/tags)
<b>Media width</b>	Min 1" (25.4mm) / Max 4.72" (120mm)
<b>Media thickness</b>	0.002" (0.06mm) to 0.011" (0.279mm) / RFID Max thickness 0.05" (1.2mm)
<b>Media length</b>	Min.: Continuous, Tear-Off 0.25" (6.35mm) Min.: Peel-Off, Cutter 1.0" (25.4mm) Max.: 50" (1,270mm)
<b>Media core diameter</b>	1.5" (38.1mm) - 3.0" (76.2mm)
<b>Media max. roll diameter</b>	8.0" (209mm)
<b>Ribbon type</b>	Wax, Wax/Resin, Resin
<b>Ribbon width</b>	Min 1.6" (40mm) / Max 4.33" (110mm)
<b>Ribbon length</b>	1476.4 ft (450m)
<b>Ribbon core diameter</b>	1.0" (25.4mm)
<b>Interface I/O</b>	Standard: Serial RS232, USB, and Ethernet 10/100Base T / Optional: Wi-Fi 802.11a/b/g/n/ac, MFi Bluetooth 5.0
<b>WiFi security encryption</b>	WEP 40/128bit, WPA Personal (PSK), WPA2 Personal (PSK), Enterprise (AES CCMP)
<b>WiFi security authentication</b>	EAP-TLS, EAP-TTLS, PEAPv0/MS-CHAPv2, PEAPv1, EAP-MDS, LEAP
<b>Remote management software</b>	PrintNet Enterprise Suite, SOTI Connect: IoT device management
<b>Memory</b>	128 MB Flash / 128 MB DDR
<b>Line input</b>	Auto Range 100 - 240 VAC (48 - 62 Hz)
<b>Fonts</b>	Font Technologies: Intellifont, TrueType, Unicode Standard Fonts: OCRA, OCRB, Courier, Letter Gothic, CG Times, CG Triumvirate/Bold/Condensed Premium Asian Fonts (Optional SD card): Simplified Chinese, Japanese, Korean, Thai Andale Asian Fonts (Optional SD card): Simplified Chinese, Traditional Chinese, Korean, Japanese PDF/ PostScript Level 3: 35 fonts
<b>Graphic formats</b>	PCX, TIFF, BMP, PNG
<b>Barcode</b>	1D barcode: BC-412, Code 11, Code 39, Code 35, Code 93, Codabar, Code128 Subsets A/B/C, Industrial 2 of 5, Interleave 2 of 5, German I-2/5, EAN-8, EAN-13, UCC/EAN-128, UPC-A, UPC-E, UPCSHIP, UPS 11, MSI, Matrix 2 of 5, PLESSEY, POSTNET, 4-state PostBar, Australian 4-state, FIM, ITF14, TELEPEN, PLANET, USPS Intelligent Mail, LOGMARS 2D barcode: PDF-417, MicroPDF-417, Maxicode, DataMatrix, QR Codes, Aztec, GS1 Databar (RSS-14)
<b>RFID</b>	RAIN UHF Passive (GS1 EPC Gen2 v2 / ISO 18000-63) Fixed Position Antenna Standard/On-Metal Tags/ Additional Tag Constructions Minimum Label/Tag Pitch 0.625" (15.9 mm) On-Metal Tag Thickness up to 0.05" (1.2mm) Printer languages: PGL, ZGL, STGL, MGL Counters: Tracks good/overstruck labels/tags
<b>Operating environment</b>	Operating Temperature: 32° to 104°F (0° to 40°C) (limitations based on selected media) / Operating Humidity: 25-85% Non-Condensing Storage Temperature: -40° to 140° F (-40° to 60° C) / Storage Humidity: 10 - 90% Non-Condensing
<b>Regulatory compliances</b>	Emissions: FCC, CE, IC, CCC, KC Safety: cTUVus, CE, IC, EAC, SMARK, NOM, CCC, KC, BIS, BSMI Environmental: RoHS, WEEE, Energy Star 3.0 RFID: FCC, CE, ANATEL, ICT, KC, MIC, NCC., SRRC, WPC WiFi/BT: US, Canada, European Union, China
<b>Physical dimension (W x H x D)</b>	10.40" (264mm) x 10.9" (276mm) x 17.9" (455mm)
<b>Weight</b>	22lbs (10kg)
<b>Options &amp; Accessories</b>	Wi-Fi 802.11a/b/g/n/ac MFi Bluetooth 5.0 Cutter Peel/Rewind Andale Asian Font Card Premium Asian Font Card OCMC (Quick Change Memory Card) RFID Encoder/Antenna System



## Global Headquarters

9F, No. 95, Minquan Road, Xindian District  
New Taipei City, Taiwan 231  
Office: +886 2 2218 6789

## EMEA

Georg-Wimmer-Ring 8b  
85604 Zorneding, Germany  
Office: +49 8106 37979 000

## Americas

3040 Saturn Street, Suite 200  
Brea, CA 92821 U.S.A.  
Office: +1 657 258 0808